

THIS DOCUMENT IS THE PROPERTY OF KEYSTONE ELECTRONICS CORP. AND SHALL NOT BE REPRODUCED, DISTRIBUTED OR USED AS A BASIS FOR MANUFACTURE WITHOUT PRIOR WRITTEN PERMISSION FROM KEYSTONE ELECTRONICS CORP.

ACTUAL SIZE

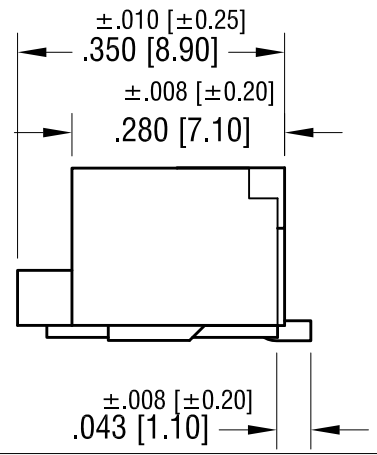
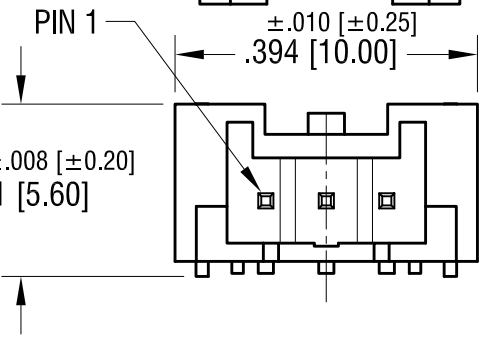
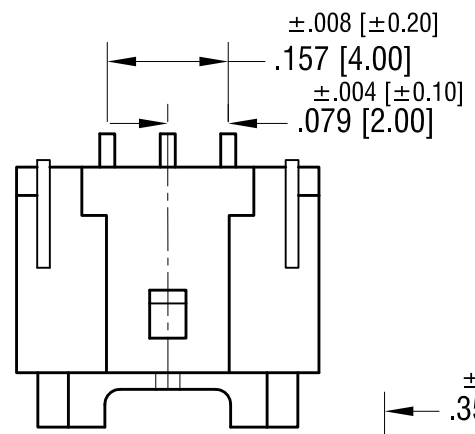
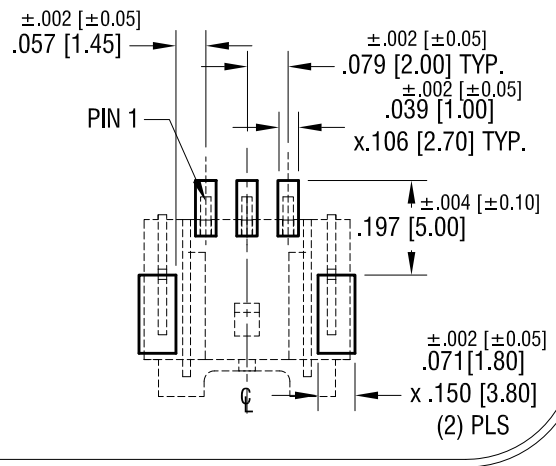
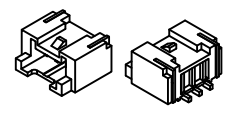

NOTE:

- 1. INSULATION: MAT'L- NYLON 6T UL94V-0
- 2. POST: MAT'L- BRASS FINISH TIN

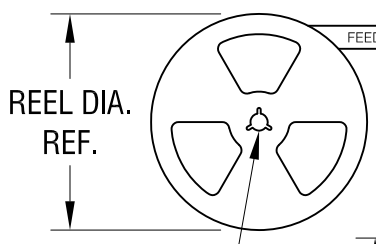

Ø.500 [Ø12.7] MIN. HOLE THRU

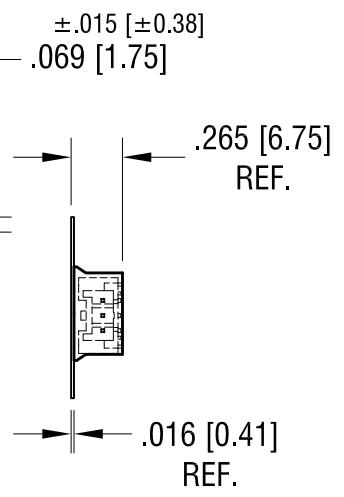
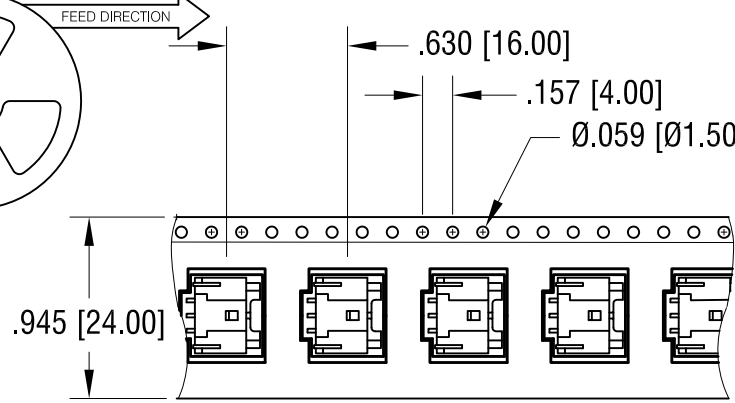

TAPE AND REEL SPECIFICATIONS:

- 4. TAPE: MAT'L - ALL CONDUCTIVE POLYSTYRENE CARRIER ANS/EIA-481 STANDARD
- 5. REEL: 15.0 [380.8] DIA. 1000 PIECES PER REEL

KEYSTONE ELECTRONICS CORP.

www.keyelco.com • NEW HYDE PARK, NY 11040 • Tel (516) 328-7500

PART NAME
SM SIDE ENTRY CONNECTOR (3 CIRCUITS)

MATERIAL
AS NOTED

FINISH AS NOTED	DRN BY NT	DATE 3.07.16
	APP'D RH	SCALE 4X

TOLERANCES INCH [MM]	CODE	DWG NO.
DECIMAL ±.005 [±0.13]	C	976
ANGULAR ± 1°		
UNLESS OTHERWISE SPECIFIED		

6.18.21	CHANGE AS PER ECN 21-055	A
DATE	DESCRIPTION	REV.

Mouser Electronics

Authorized Distributor

Click to View Pricing, Inventory, Delivery & Lifecycle Information:

[Keystone Electronics:](#)

[976](#)