

REV.	DATE	DESCRIPTION
NC	05/01/04	INITIAL RELEASE
A	06/09/06	REMOVE "BULKHEAD" FROM PART DESCRIPTION

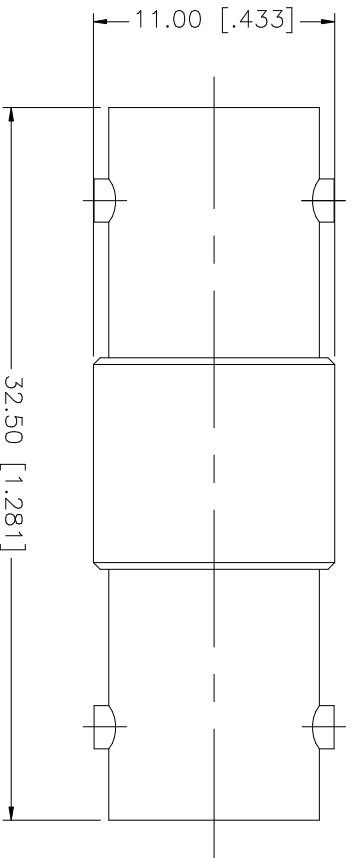

QTY	FINISH	MATERIAL	DESCRIPTION
1	GOLD	PHOS. BRONZE	CONTACT PIN
1	NATURAL	DELFIN	INSULATOR
1	NICKEL	BRASS	BODY
			DESCRIPTION

UNLESS OTHERWISE SPECIFIED DIMENSIONS ARE IN INCHES AND FOR CUSTOMER REFERENCE ONLY.		UNLESS OTHERWISE SPECIFIED DIMENSIONS ARE IN MILLIMETERS AND FOR CUSTOMER REFERENCE ONLY.	
TOLERANCES FOR INCHES ARE:		TOLERANCES FOR MILLIMETERS ARE:	
0.3 - 8mm	± 0.20mm	0.3 - 8mm	± 0.20mm
8 - 30mm	± 0.40mm	8 - 30mm	± 0.40mm
30 - 120mm	± 0.50mm	30 - 120mm	± 0.50mm
UNLESS OTHERWISE SPECIFIED TOLERANCES FOR INCHES ARE:		UNLESS OTHERWISE SPECIFIED TOLERANCES FOR INCHES ARE:	
.020 - .315	= ± 0.007"	.020 - .315	= ± 0.007"
.315 - 1.180	= ± 0.015"	.315 - 1.180	= ± 0.015"
1.180 - 4.724	= ± 0.020"	1.180 - 4.724	= ± 0.020"

APPROVALS	DATE
DRAWN G.R.S.	06/09/06
CHECKED	
ISSUED	

CAD FILE	C:/112/112445.DWG
SHEET	1 OF 1

DWG. NO.	112445.DWG	REV.	A	SIZE	A	SCALE	NA
----------	------------	------	---	------	---	-------	----

PART DESCRIPTION	
BNC FEMALE TO FEMALE ADAPTER	
PART NO.	112445

# Mouser Electronics

Authorized Distributor

Click to View Pricing, Inventory, Delivery & Lifecycle Information:

[Amphenol:](#)

[112445](#)